

**1987 REPAIR MANUAL**

Shimano American Corporation, One Shimano Dr.  
 Irvine, CA 92718

**TO ORDER:**  
 This reel belongs to the "Rear Drag" series.  
 Please order parts using the abbreviation  
 "RD" and the part number.

※ Please look here for "S" mark here  
 (e.g. 87<sup>S</sup> (KB) - JAPAN)

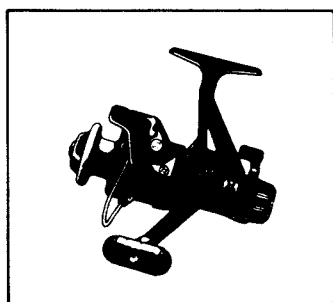

**EXPLODED PARTS VIEW  
 MARK II**

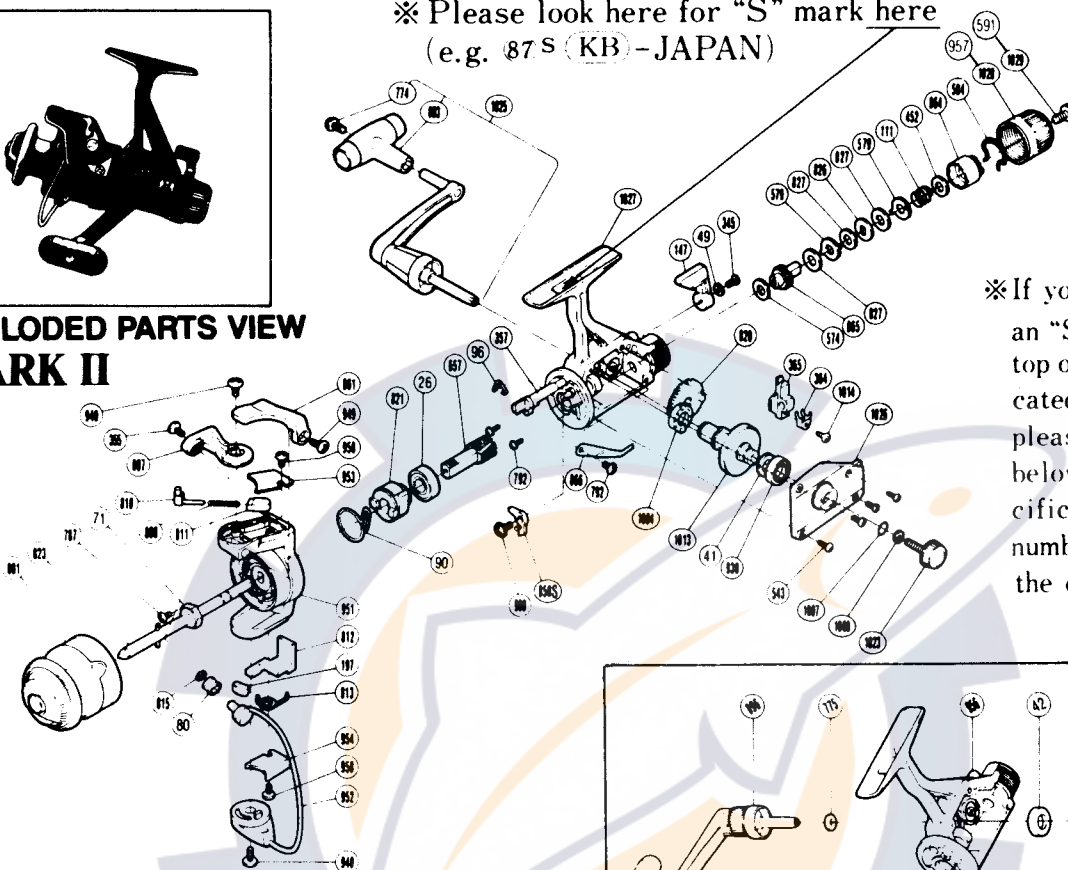

※ If your reel does not have an "S" mark molded on the top of the reel foot as indicated in the exploded view, please use the parts view below to order these specific parts. All other parts numbers are as shown in the exploded view.

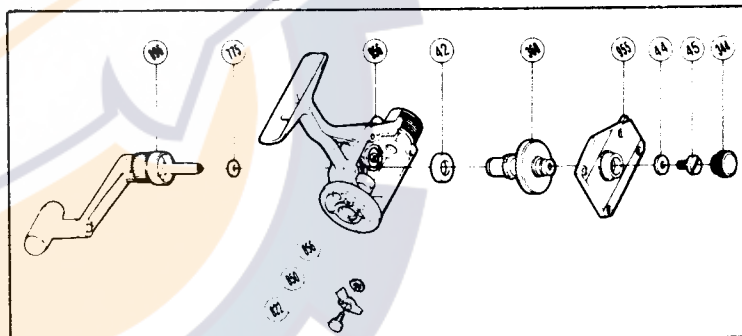

**PARTS LIST**

**PART # DESCRIPTION**

- 26. Ball Bearing
- 41. Drive Gear Washer
- 42. Bushing
- 44. Handle Lock Washer
- 45. Handle Lock Screw (Originally 796)
- 49. Lock Washer
- 71. Rotor Nut
- 80. Line Roller
- 90. Anti-Reverse Pawl Spring
- 96. Anti-Reverse Cam Spring
- 111. Drag Coil Spring
- 147. Anti-Reverse Lever
- 197. Bail Trip Slide Cam
- 344. Handle Screw Cap
- 345. Anti-Reverse Lever Screw
- 355. Line Roller Screw (orig. 959)
- 357. Anti-Reverse Cam
- 360. Drive Gear
- 363. Slider Retainer Screw
- 364. Oscillating Slider Retainer
- 365. Oscillating Slider
- 452. Drag Spring Washer "A"
- 543. Side Cover Screw
- 574. Drag Washer "C<sub>2</sub>"
- 579. Eared Washer "B"
- 584. Hold Click Spring

**PART # DESCRIPTION**

- 591. Drag Knob Screw (original)
- 657. Pinion Gear
- 775. Handle Lock Spacer
- 787. Nut Lock Screw
- 792. Multi Purpose Screw
- 801. Spool Assembly (Universal)
- 807. Bail Arm
- 808. Bail Spring
- 810. Bail Spring Guide A
- 811. Bail Spring Guide B
- 812. Bail Trip Lever
- 813. Lever Spring
- 815. Line Roller Washer
- 820. Oscillating Gear
- 821. Anti-Reverse Ratchet
- 822. Anti-Reverse Pawl Screw
- 823. Main Shaft
- 826. Key Washer "A"
- 827. Drag Washer "H."
- 850. Anti-Reverse Pawl
- 856. Anti-Reverse Pawl Spacer
- 861. Quick-Fire II Trigger
- 864. Pressure Screw
- 865. Drag Shaft
- 866. Drag Click
- 896. Handle Assembly
- 930. Ball Bearing
- 940. Bail Trip Cam Screw

**PART # DESCRIPTION**

- 949. Trigger Screw
- 951. Rotor
- 952. Bail Assembly
- 953. Bail Spring Cover
- 954. Bail Trip Cover
- 955. Side Cover
- 956. Body
- 957. Drag Knob (original)
- 958. Bail Trip Cover Screw
- 998. Anti-Reverse Pawl Screw ("S" Version)
- 1004. Bushing ("S" Version)
- 1007. Lock Washer Retainer ("S" Version)
- 1008. Handle Lock Washer ("S" Version)
- 1013. Drive Gear ("S" Version)
- 1014. Slider Retainer Screw ("S" Version)
- 1023. Handle Screw Cap ("S" Version)
- 1025. Handle Assembly ("S" Version)
- 1026. Side Cover ("S" Version)
- 1027. Body ("S" Version)
- 1028. Drag Knob ("S" Version)
- 1029. Drag Knob Screw ("S" Version)